

LOCATOR® System

LOCATOR® System

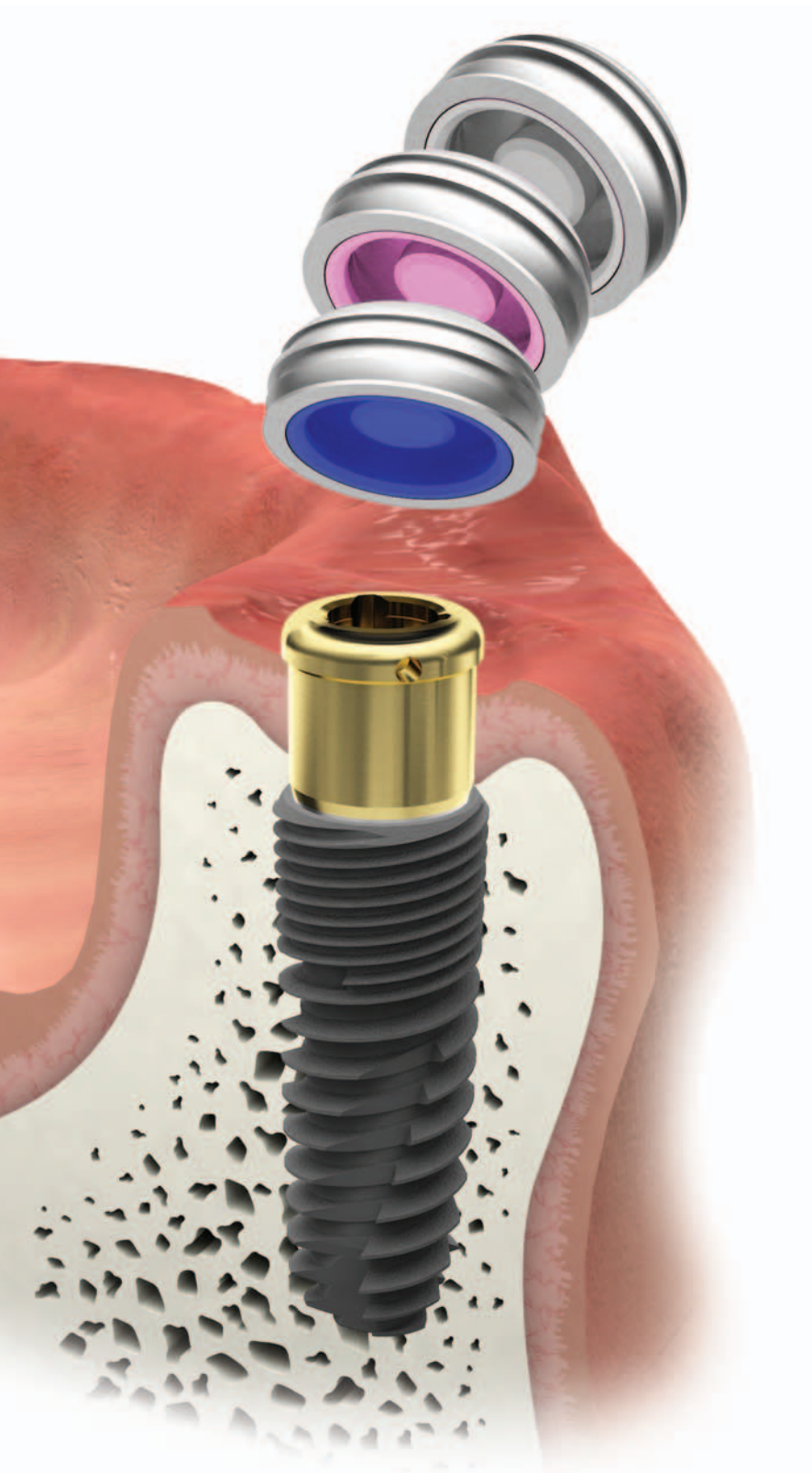

● HIOSSEN LOCATOR® SYSTEM ↙



- **Features**
 - Stable dual retention & optimal holding capabilities against various retention forces (6N, 12N, 22N)
 - Excellent durability
 - Possible denture restorations even at small vertical dimension
 - Accommodate up to 40° divergence between two implants
 - Retention males can be easily placed & removed with core tool
- **Indications**
 - Implant retained overdenture in the mandible or maxilla.
- **Contraindications**
 - Tooth and implant supported overdenture
 - Divergences greater than 40° between two implants.

● HIOSSEN LOCATOR® SYSTEM ↙

Description	Component Flow Diagram	Tool
Replacement Male	 0° ~10° divergence 10° ~20° divergence	
Denture Cap		 Core Tool
Black Processing Male		
Lab Analog		
Impression Coping		 Block out spacer
Abutment	 HS System HG System	 Torque Driver
Fixture		

● Procedure of LOCATOR® SYSTEM

■ Fabricating individual tray



■ Taking impression & Fabricating working model

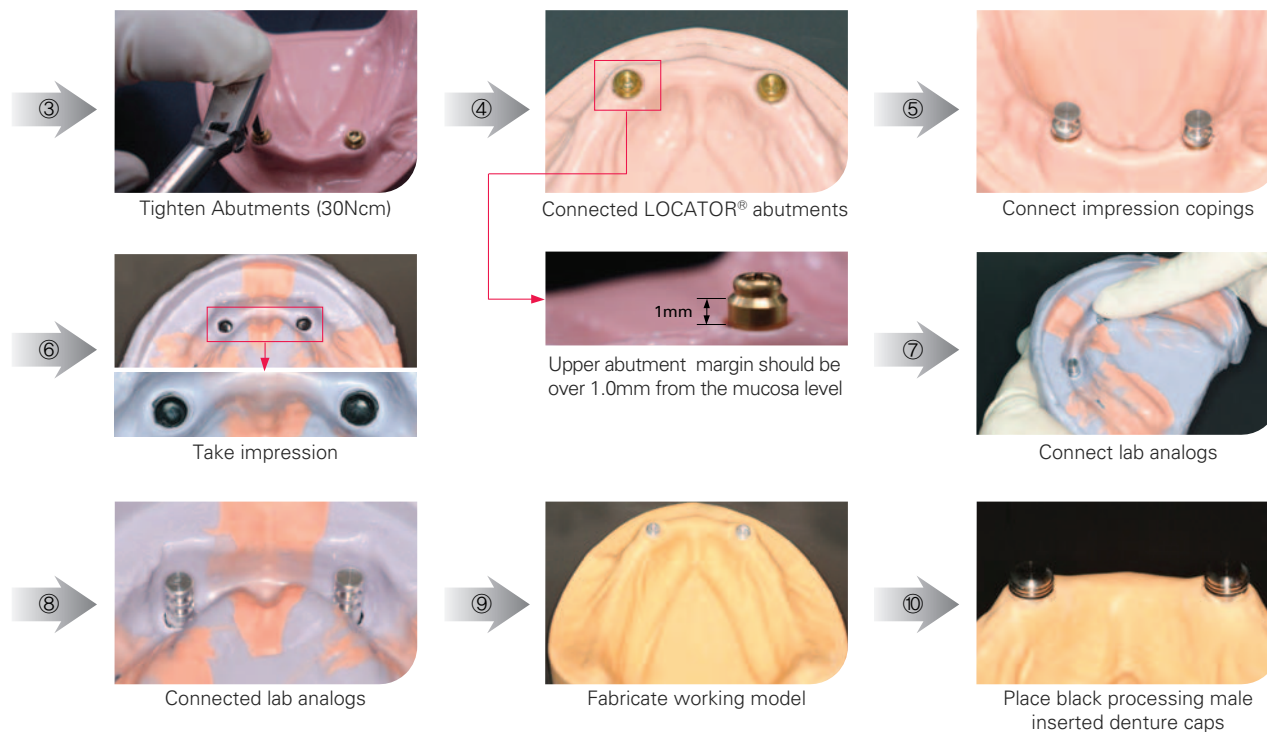

Note

- During wax rim fabrication, use denture cap with black processing male for retention on bite registration.

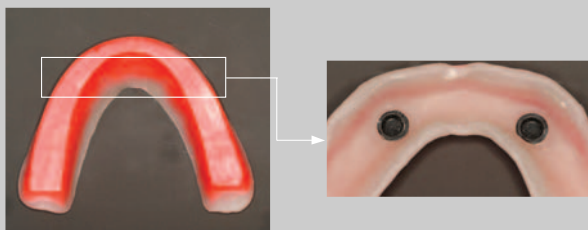

• Selecting the replacement males

In the case of implant divergences of more than 10° to 20°, using extended range replacement males (red or green) can give much retention and durability.

- When selecting males, it is recommended to use the Blue male (least retention) first. If the patients feels that they are too loose, then use the ones with greater retention force.

Blue → Pink → Clear

■ Curing denture & changing replacement males (Basic procedure)

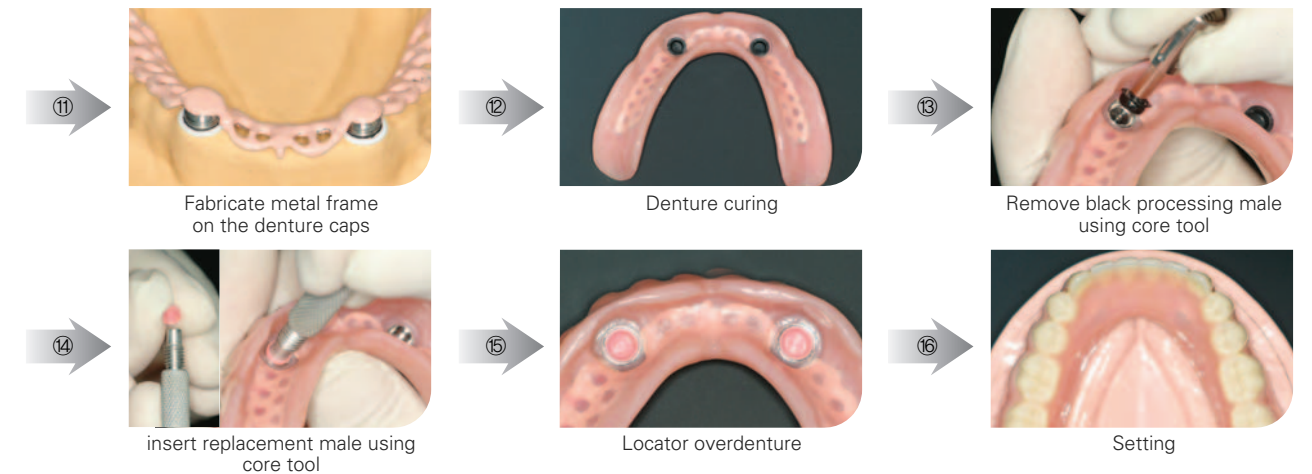

■ Curing denture & changing replacement males (Intra-oral Technique)

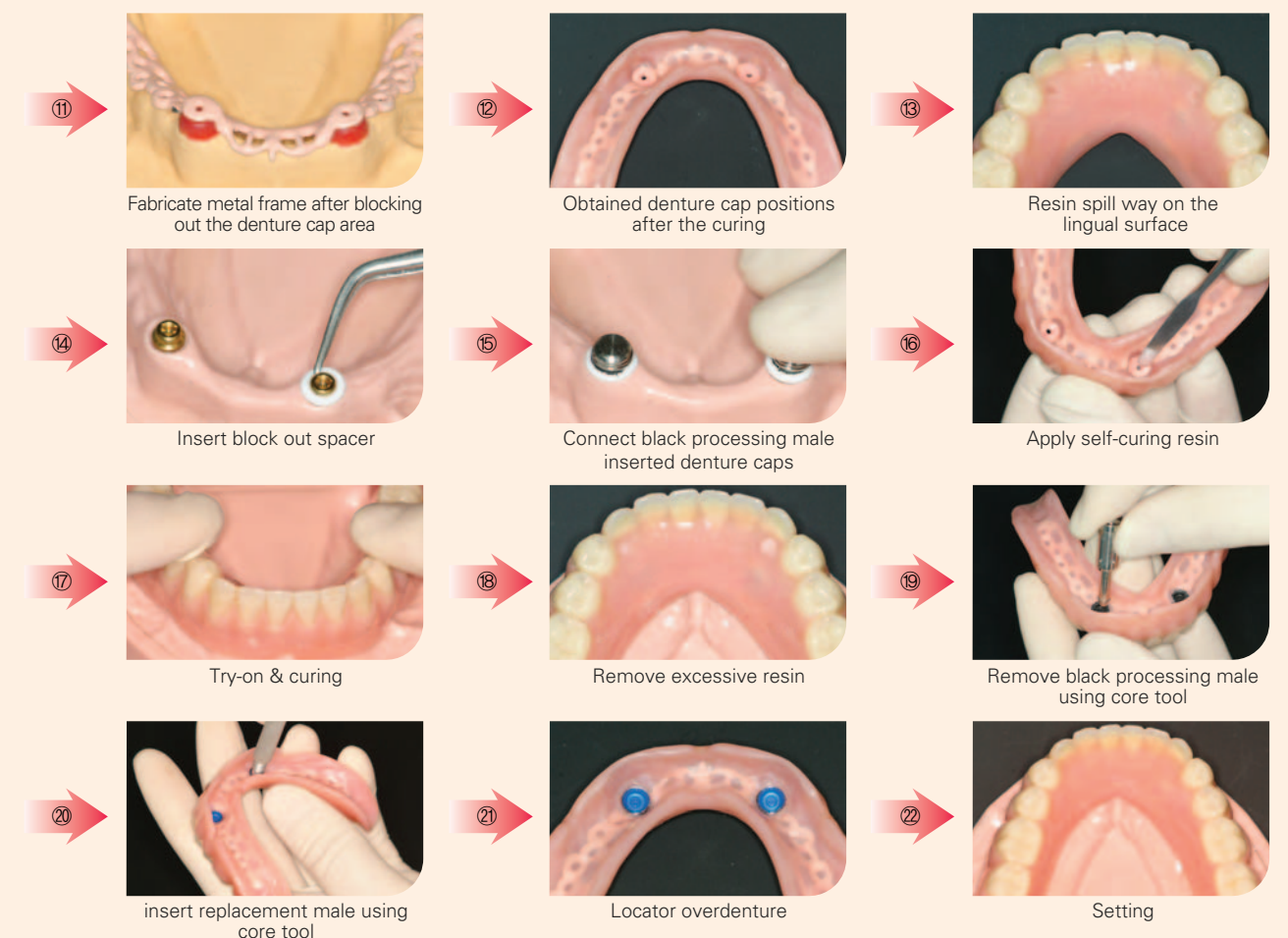

HIOSSEN LOCATOR® SYSTEM

Fixture level Impression

When using Hiossen fixture level impression components, It is also possible to take impression at the level of fixture without LOCATOR® abutment.

HS System

Pick-up

Transfer

Fixture Impression Coping

Fixture Lab Analog

HG System

Pick-up

Transfer

Fixture Impression Coping

Fixture Lab Analog

①

②

③

④

⑤

⑥

Using The LOCATOR® Core Tool

► When inserting replacement males into denture cap

► When removing replacement male from denture cap

Gap

① Unscrew the tip until the gap between the tip & the body is visible

② Press on the male inside of denture cap with the tip and remove.

③ Twist the tip clock-wise until the male separates.

HS LOCATOR® Abutment

Regular

P : \varnothing 4.8

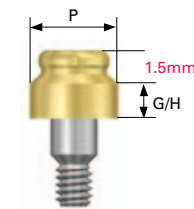

Platform x G/H	Code
\varnothing 4.8 x 0.7mm	HSLCA4810R
\varnothing 4.8 x 2.0mm	HSLCA4820R
\varnothing 4.8 x 3.0mm	HSLCA4830R
\varnothing 4.8 x 4.0mm	HSLCA4840R

HG LOCATOR® Abutment

Mini

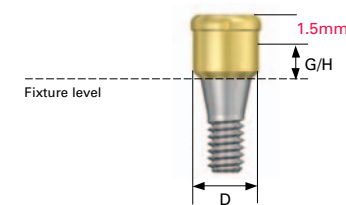

Diameter x G/H	Code
\varnothing 3.7 x 1.0mm	HGLCA3510M
\varnothing 3.7 x 2.0mm	HGLCA3520M
\varnothing 3.7 x 3.0mm	HGLCA3530M
\varnothing 3.7 x 4.0mm	HGLCA3540M
\varnothing 3.7 x 5.0mm	HGLCA3550M

Standard

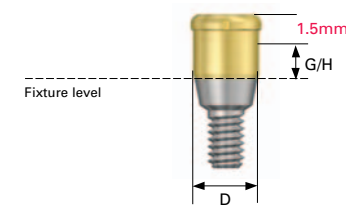

Diameter x G/H	Code
\varnothing 3.7 x 1.0mm	HGLCA4010S
\varnothing 3.7 x 2.0mm	HGLCA4020S
\varnothing 3.7 x 3.0mm	HGLCA4030S
\varnothing 3.7 x 4.0mm	HGLCA4040S
\varnothing 3.7 x 5.0mm	HGLCA4050S

Component & Tool

LOCATOR® Impression Coping (4Pack)

LICS

LOCATOR® Lab Analog (4Pack)

LAL40S LAL50S

LOCATOR® Core Tool

LCCT

LOCATOR® Male Processing Kit (2Pack)

LMPS

LOCATOR® Replacement Male (4Pack)

6N 12N 22N LRM06S LRM12S LRM22S

LOCATOR® Extended Replacement Male (4Pack)

6N 12N LEM06S LEM12S

LOCATOR® Black Processing Male (4Pack)

LBPS

LOCATOR® Block-out Spacers (20 pack)

LBSS

LOCATOR® Torque Driver

TWLDL TWLDS